

3YW Series - Three Electrode

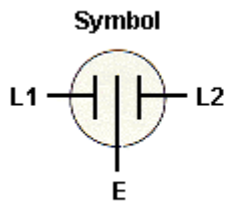

Model A

Fig. 1

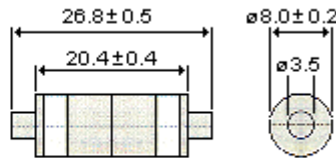

Electrodes : Nickel Plated
Unit Weight : 5.7g
Units : mm

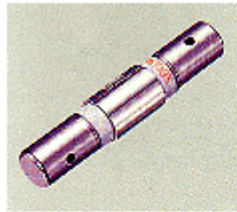

Model YZ Fig. 2

Electrodes : Nickel Plated
Unit Weight : 9.3g
Units : mm

Note :

1. Insulation Resistance shall be measured with the following voltages for each nominal DC Sparkover Voltage.

Nominal DC Sparkover Voltage	Measuring Voltage
90V	DC 50V
230 ~ 400V	DC 100V

2. DC Holdover Voltage shall be measured in accordance with the ITU-T K.12, Test Circuit or the IEEE C62.31-1987 Test Circuit.

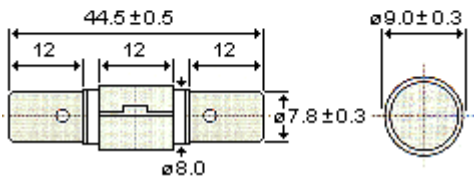

Part Number	See Fig. 1	3YW-90A	3YW-230A	3YW-350A	3YW-400A
	See Fig. 2	3YW-90YZ	3YW-230YZ	3YW-350YZ	3YW-400YZ
DC Sparkover Voltage (L1-E)(L2-E)	100V/S	90V ± 20%	230V ± 20%	350V ± 20%	400V ± 25%
Impulse Sparkover Voltage (L1-E)(L2-E)	100V/μs	≤ 500V	≤ 600V	≤ 650V	≤ 700V
	1kV/μs	≤ 700V	≤ 800V	≤ 850V	≤ 900V
Insulation Resistance	See Note 1	≥ 10,000Mohm	≥ 10,000Mohm	≥ 10,000Mohm	≥ 10,000Mohm
Capacitance	1MHz	≤ 3.0pF	≤ 3.0pF	≤ 3.0pF	≤ 3.0pF
DC Holdover Voltage	See Note 2	≤ 52V	≤ 150V	≤ 150V	≤ 150V
Impulse Life(L1 + L2-E)	10/1000μs, 1000A	1,000 times	1,000 times	1,000 times	1,000 times
Impulse Discharge Current, 8/20μs (L1 + L2-E)	Single	40kA	40kA	40kA	40kA
	Repeat 10 times (5 Times - each polarity)	20kA	20kA	20kA	20kA
AC Discharge Current, 50Hz (L1 + L2-E)	Single (9 cycles)	400A	400A	400A	400A
	Repeat 10 times (1 second)	20A	20A	20A	20A